

# Shackle Series

# 美式D形卸扣G/S210

## US Type Forged Screw Pin Chain Shackle G/S210

Model: G/S210

用途：主要用于索具不会带动销轴旋转的场合。

类型：D型

材质：采用优质合金钢制造。

载荷：试验载荷为2倍极限工作载荷，破断载荷为4倍极限工作载荷。

Uses: mainly used for rigging will not drive pin axis occasions.

Type: D

Material: high quality alloy steel.

Load: the test load is 2 times the working load, and the breaking load is 4 times the working load.

Capacities 1/3 to 55 tons.

Hot dip galvanized or electric galvanized.

Drop forged, quenched and tempered with alloy pins.

Working load limit permanently shown on every shackle

Max proof load is 2.2 times of the working load limited.

Min. Breaking strength is 6 times or 4 times of the W.L.L. as requirement.

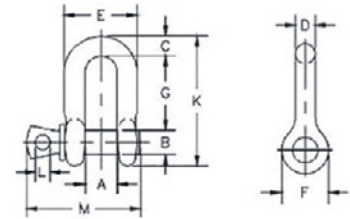

### 美式D形卸扣G/S210参数： SPECIFICATION

规格 Nominal Size (in)	载荷 WLL (t)	净重 Weight Each (Lbs)	主要尺寸 Dimensions(in.)										公差 Tolerance +/-	
			A	B	C	D	E	F	G	K	L	M	G	A
1/4	1/2	0.11	0.47	0.31	0.25	0.25	0.97	0.62	0.97	1.59	0.19	1.43	0.06	0.06
5/16	3/4	0.17	0.53	0.38	0.31	0.31	1.15	0.75	1.07	1.91	0.22	1.71	0.06	0.06
3/8	1	0.28	0.66	0.44	0.38	0.38	1.42	0.92	1.28	2.31	0.25	2.02	0.13	0.06
7/16	1-1/2	0.43	0.75	0.50	0.44	0.44	1.63	1.06	1.48	2.67	0.31	2.37	0.13	0.06
1/2	2	0.59	0.81	0.63	0.50	0.50	1.81	1.18	1.66	3.03	0.38	2.69	0.13	0.06
5/8	3-1/4	1.25	1.06	0.75	0.63	0.63	2.32	1.50	2.04	3.76	0.44	3.34	0.13	0.06
3/4	4-3/4	2.63	1.25	0.88	0.81	0.75	2.75	1.81	2.40	4.53	0.50	3.97	0.25	0.06
7/8	6-1/2	3.16	1.44	1.00	0.97	0.88	3.20	2.10	2.86	5.33	0.50	4.50	0.25	0.06
1	8-1/2	4.75	1.69	1.13	1.00	1.00	3.69	2.38	3.24	5.94	0.56	5.13	0.25	0.06
1-1/8	9-1/2	6.75	1.81	1.25	1.25	1.13	4.07	2.69	3.61	6.78	0.63	5.71	0.25	0.06
1-1/4	12	9.06	2.03	1.38	1.38	1.25	4.53	3.00	3.97	7.50	0.69	6.25	0.25	0.13
1-3/8	13-1/2	11.63	2.25	1.50	1.50	1.38	5.01	3.31	4.43	8.28	0.75	6.83	0.25	0.13
1-1/2	17	15.95	2.38	1.63	1.62	1.50	5.38	3.62	4.84	9.05	0.81	7.33	0.25	0.13
1-3/4	25	29.75	2.88	2.00	2.12	1.75	6.38	4.19	5.78	10.97	1.00	9.06	0.25	0.13
2	38	42.31	3.25	2.25	2.36	2.10	7.25	5.00	6.77	12.74	1.13	10.35	0.25	0.13
2-1/2	55	71.75	4.12	2.75	2.63	2.63	9.38	5.68	8.07	14.85	1.38	13.00	0.25	0.25